



Replacement

CAUTION

Put on gloves to protect your hands.

Information

- Use a plastic panel removal tool to remove interior trim pieces without marring the surface.
- Take care not to bend or scratch the trim and panels.

[Steering column shroud upper panel]

1. Remove the crash pad side cover [LH] (A) by using a remover.

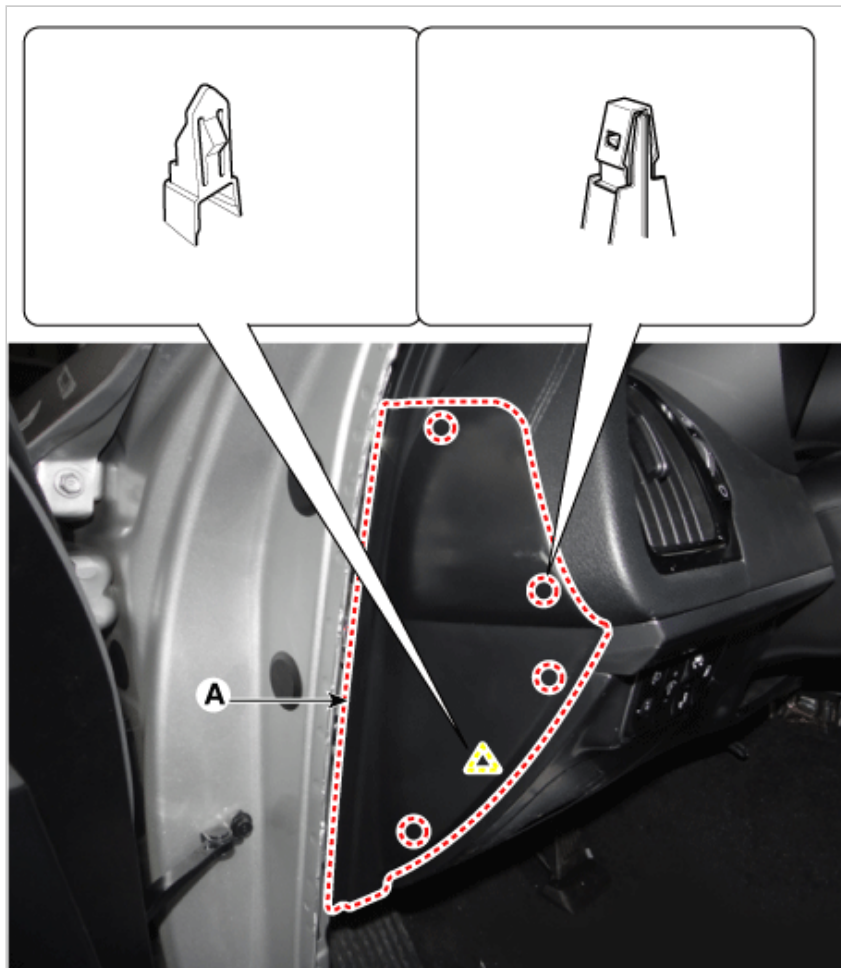

2. Separate the crash pad lower panel (A) after loosening the bolts and screws.

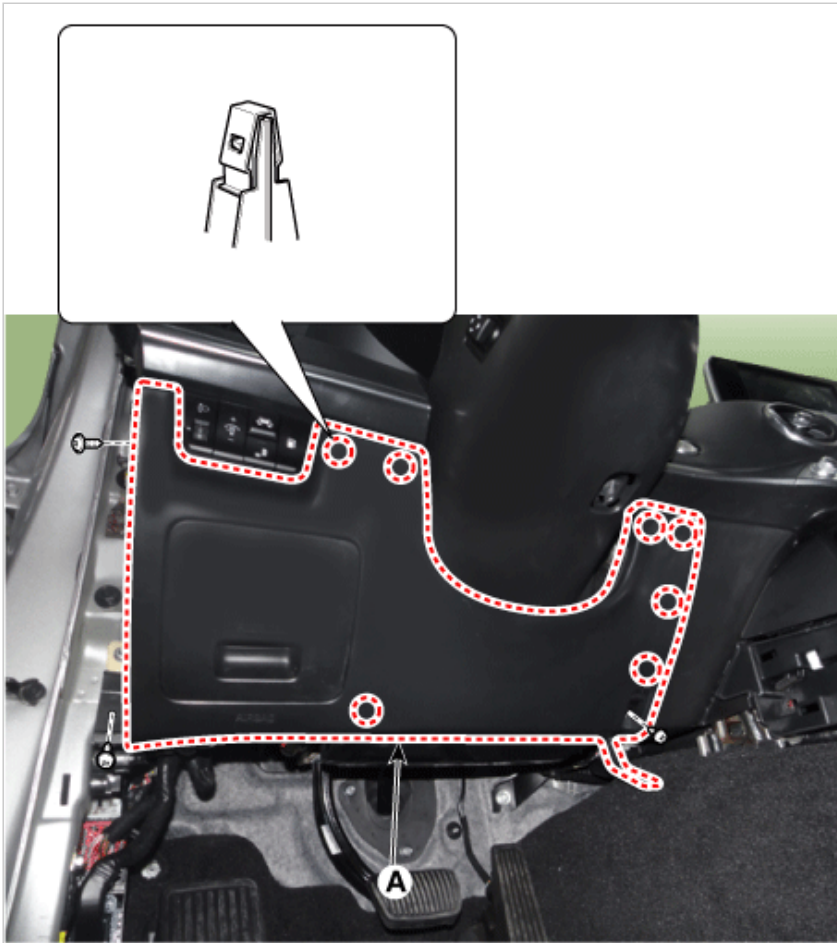

3. Disconnect the crash pad lower switch connector (A).



4. Remove the crash pad garnish [LH] (A) after loosening the mounting screws.

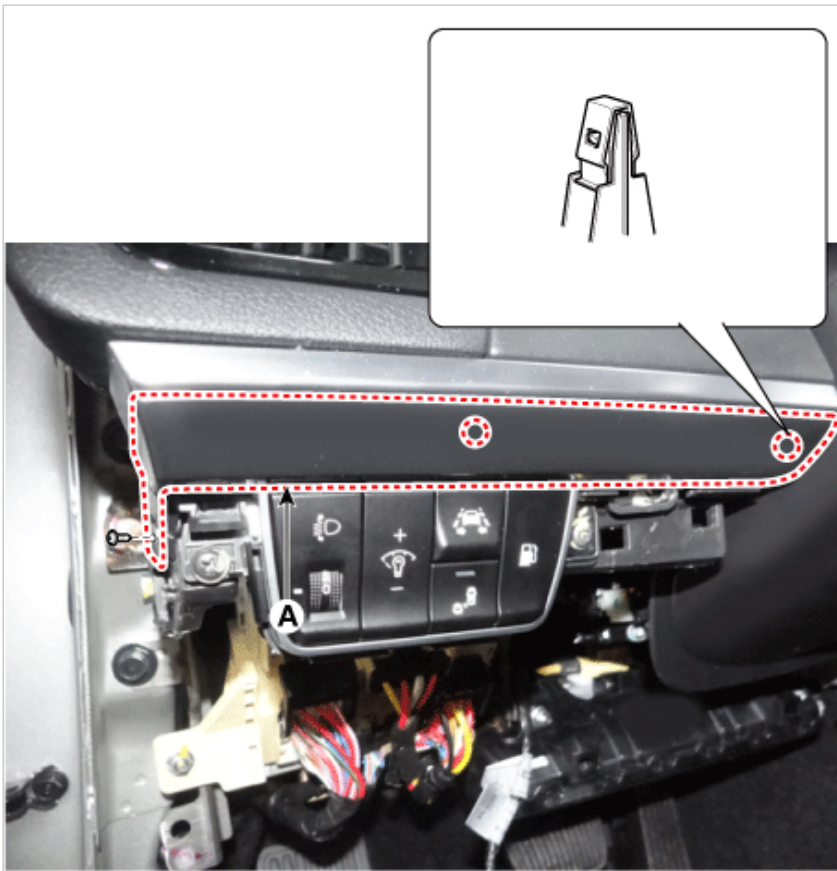

5. Remove the crash pad driver side panel (A) after loosening the mounting screws.

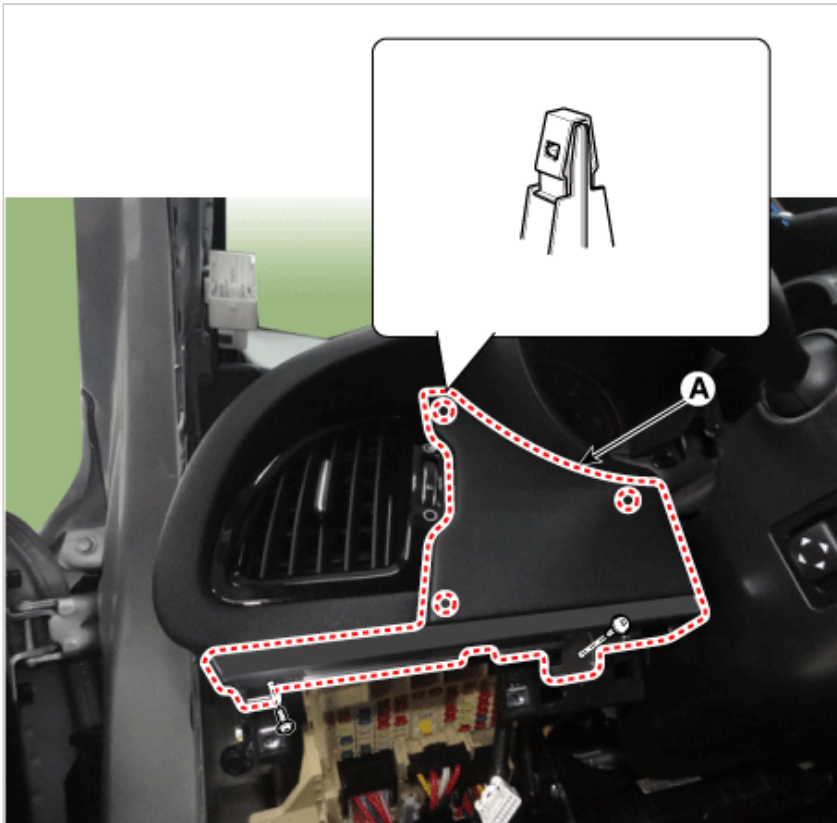

6. Remove the crash pad side cover [RH] (A) by using a remover.

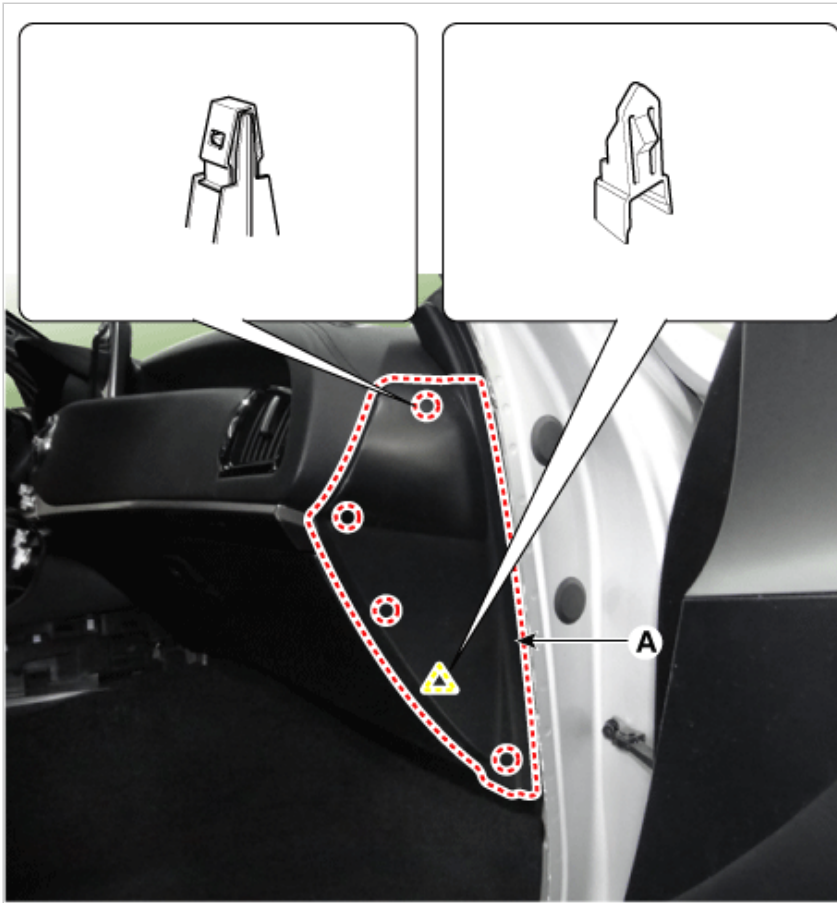

7. Remove the crash pad garnish [RH] (A) after loosening the mounting screws.

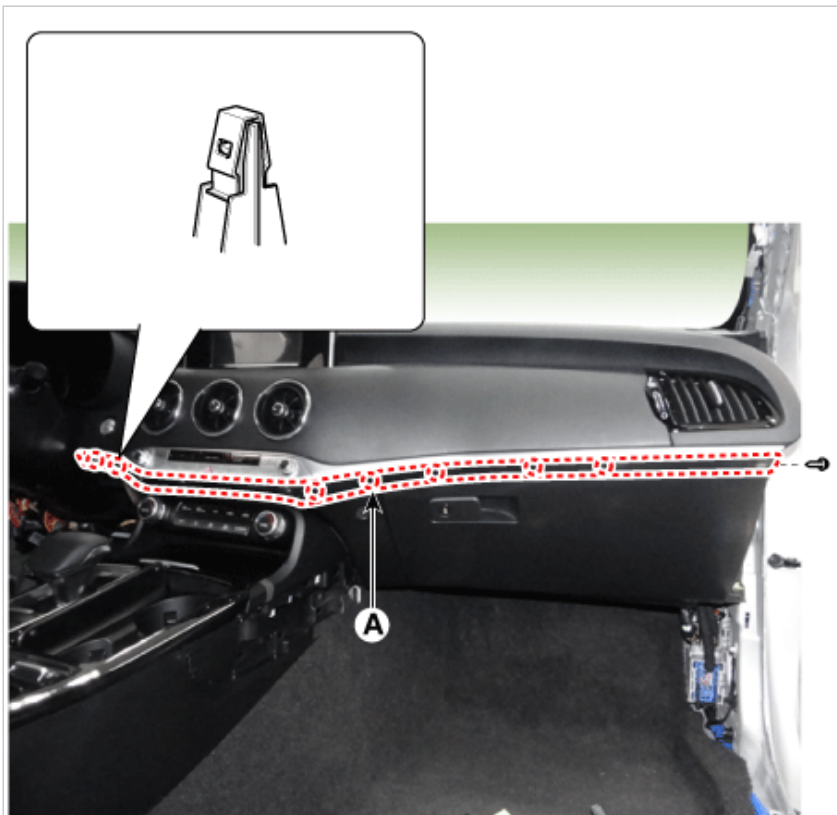

8. Separate the crash pad passenger side panel (A) after loosening the mounting screws.

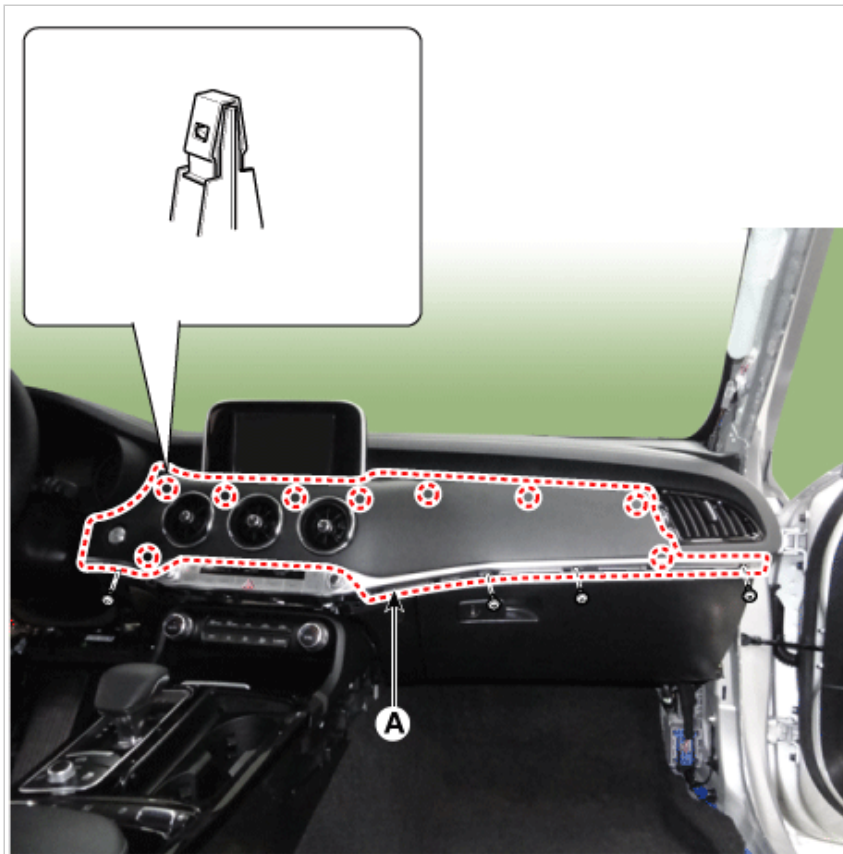

9. Disconnect the start/stop button connector (A) and then remove the crash pad garnish.



10. Remove the cluster fascia panel (A) by using a remover.

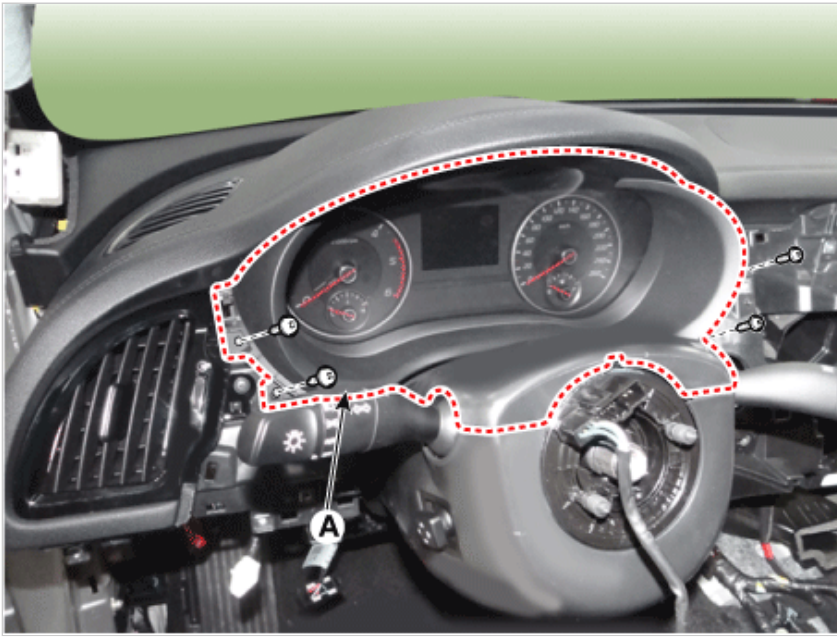

11. Install in the reverse order of removal.

i Information

- Make sure the connector are connected in properly.
- Replace any damaged clips.

[Steering column shroud lower panel]

1. Remove the crash pad upper panel.
2. Remove the steering column shroud lower panel (A) after loosening the mounting screws.



3. Install in the reverse order of removal.

i Information

- Make sure the connector are connected in properly.
- Replace any damaged clips.